



"CHIEF" CAMPING TRAILER

OWNERS INSTRUCTION MANUAL



1 Wheel your Chief to the desired location.



2 Release and position front body legs to 7th notch. To position rear legs, release and push down to ground level. To adjust trailer body, place foot on leg base, lift up slightly on trailer corner and bring leg lock pin to a notch or two higher, leveling trailer. Remove travel cover.



3 Slide ridge telescope bow off trailer into a vertical position beside trailer. Unzip tent door. (To eliminate vacuum.)

TO RAISE TENT AT CAMPING SPOT



4 Grasp canvas and pull to raise center telescope bow to position.



5 Attach elastic hooks, on outside corner of floor, to trailer legs. Stretch floor out from trailer and stake down.



Vesely Manufacturing Co.

2101 NORTH LAPEER ROAD
LAPEER, MICHIGAN



TO RAISE TENT AT CAMPING SPOT (continued)



Be sure ridge telescope bow is in sleeve on side of tent, then extend bow till tent is straight. Stake out support ropes from top corners of ridge



Extend center telescope bow to straighten slack from roof over bed.



Snap tent to trailer below storage compartment.

For th
have

SO
the fol
(



Spree
canop
canop
canop

TO STRIKE TENT FOR TRAVELING



Zip up all windows. Unsnap tent where attached below storage compartment.

Release lock and slide center telescope bow together. Zip door closed. Release elastic hooks from trailer legs. Pull all stakes.



Release lock and slide ridge telescope bow together and move this assembly, with tent attached, to side of trailer.



Pull hip bow down to trailer folding tent under.

Apache owners who purchased the optional canopy with an ADD-A-ROOM or SCREEN ENCLOSURE. Following instructions apply:

(ADD-A-ROOM shown)



1 Stake out counter guy rope on back of tent. Zip canopy to tent.



2 Assemble two piece center canopy pole and stake out. Then stake out the two outer canopy poles.



3 Zip out Add-A-Room and/or screen under with screen door lined up with center pole. Secure grommet tabs under poles.



4 Zip Add-A-Room and/or screen to face of tent and to eave of canopy. Stake down two corners nearest trailer. (Slide Add-A-Room floor under tent floor.)



5 TO REMOVE OPTIONAL ADD-A-ROOM AND/OR SCREEN ENCLOSURE:

(Close windows on Add-A-Room.) Pull stakes and loosen all ties. Unzip option from canopy. Straighten canvas on ground under canopy. Fold twice and roll up. Untip canopy from tent and roll up.



4 Pull center telescope bow down, once again folding tent under.



5 Fold remaining tent, with ridge telescope bow attached onto trailer.



6 Fold weather flap under bow assembly. Replace road cover.



7 Release rear body leveling legs by lifting up on body corner and holding leg lock pin away from notches. Still holding pin pull leg up and lock in place. To assist in folding front legs-tilt trailer.



"SMOKY" THE BEAR SAYS

"Make sure your fire is OUT and your campsite CLEAN so that others may enjoy the woods as you have."

A FEW SUGGESTIONS TO ASSURE YOURSELF OF CAREFREE TRIPS FOR YEARS TO COME

CANVAS

The tent portion of your unit is one of the finest materials of it's type available. 13 oz. ceilings with 11 oz. side walls Vivatex treated. With proper care it will not require any further treatment for years to come. If any areas in the tent require retreating because of a mishap, we recommend Sail-Craft spray.

Adjustments are provided on telescope bows and guy ropes to relieve excess tension during wet weather. As with all canvas shelters it is recommended that the tent be soaked several times to close seams prior to first camping trip.

BODY

Tent may be struck for daily traveling when wet but should be dried and aired thoroughly before storing.

Any gear carried on bed should be packed UNDER folded tent.

Lock door before putting trailer on the road.

Waxing will help prolong the lustre of the body and act as a buffer to road salts.

Heavy items that have few points of contact with the bottom of the box should be padded and light gear packed around to prevent sliding.

Use powdered graphite occasionally as lock lubricant.

When packing compartments try to apportion weight equally. At hitch level the tongue weight of a properly loaded trailer will be about that of a beverage case - 40 lbs.

Record key number on registration in case of loss.

RUNNING GEAR

Proper inflation will prevent overheating and prolong tire life. A pressure of 45 lbs. is recommended when trailer is empty and 60 lbs. when trailer is loaded. (400 lb. payload.)

The Goodyear Tire Co. warrants your Apache tires - should adjustment be necessary take your tire to your nearest Goodyear dealer.

Repack wheel bearings every 2000 or 3000 miles. Be sure wheel spins freely after packing.

Check tongue, spring assembly, U bolts and wheel bolts before putting unit in service.

If replacement parts are needed, they may be ordered through your Apache Dealer.

Happy Apache Camping!

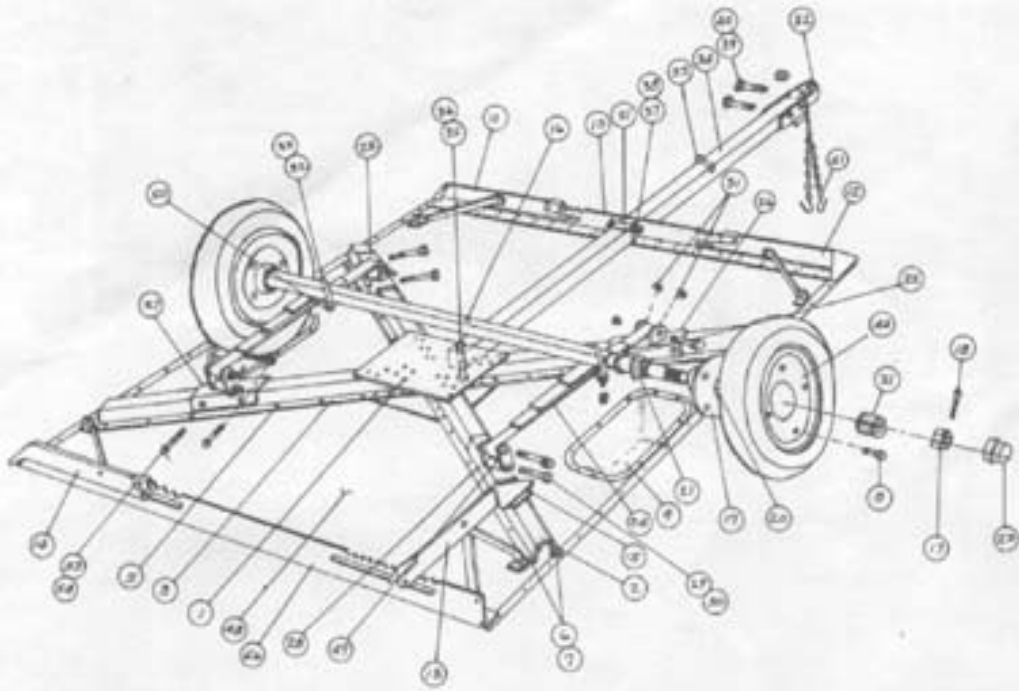

UNDI

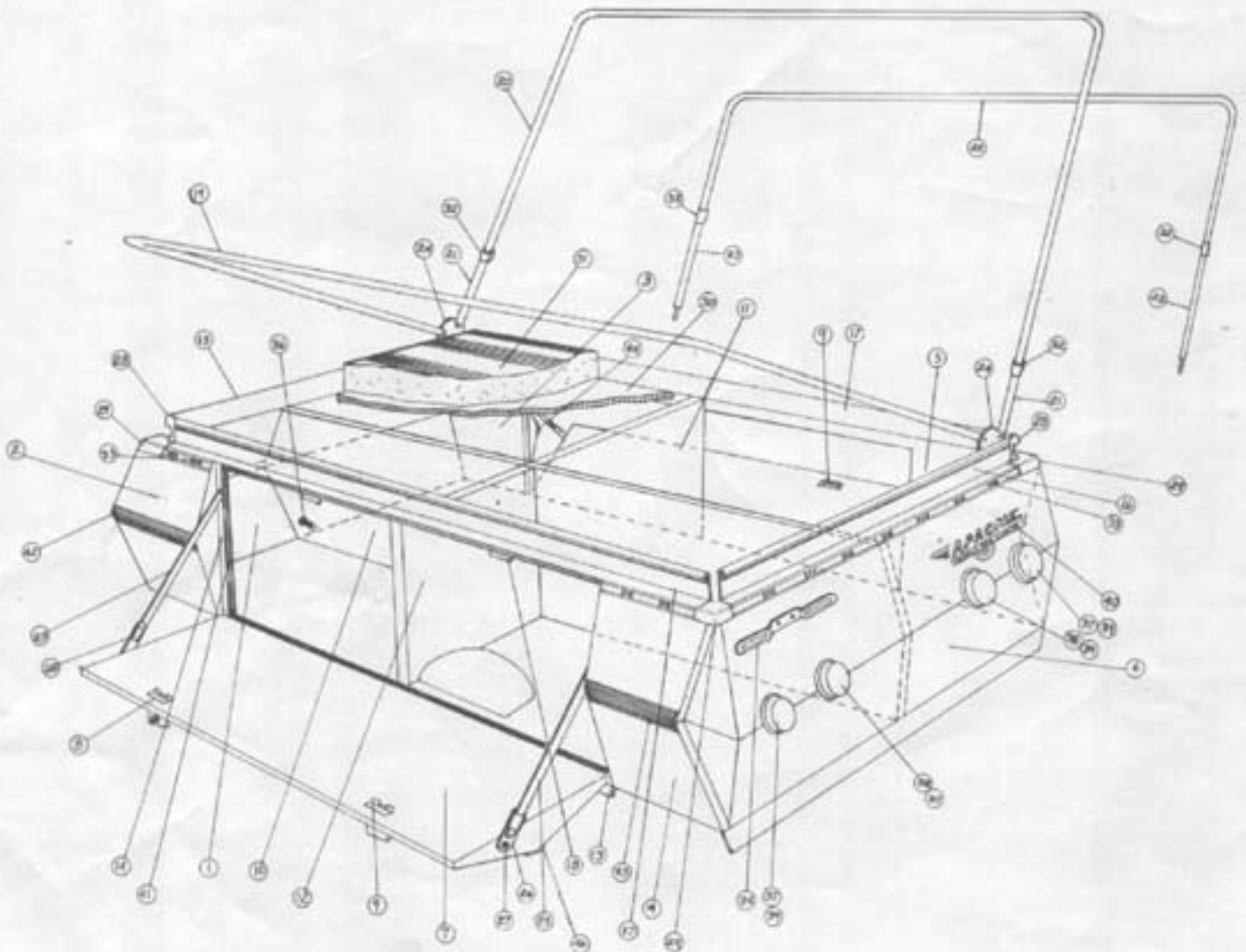

PARTS LIST

APACHE CHIEF CAMPING TRAILER

Item	Part No.	Req.	Description	Item	Part No.	Req.	Description
1	MB3-317	2	X Fr. Cent. Sup. Plate	30	PUNO-17R	6	Shackle Bolt Nuts
2	MB3-382	2	Short Hat Section	31	PUNB-24	12	Rubber Shkle. Bushings
3	MB3-383	1	Long Hat Section	32	PU3-351	2	U Bolt
4	SB3-330	1	Comp. X Fr. Assembled	33	PUNO-17R	4	U Bolt Nut
5	FB3-468	40	X Frame Screws	34	MB3-358	1	Tongue
6	FB3-345	8	X Frame Bolts	35	PU3-284	1	Tongue Bolt
7	PEBQ2-181	8	X Frame Nuts	36	PU3-289	1	Tongue Bolt Nut
8	PUNB-9	8	Log Bolts	37	PU3-284	2	Tongue Clamp Bolt
9	MEBQ2-93	2	Wheel Well	38	PU3-289	2	Tongue Clamp Nut
10	MB3-294	1	Fr. Reinforcing Angle	39	PUNB-28	2	Trailer Coupler Bolt
11	HU3-282	1	Rt. Fr. Leveling Leg Assy	40	PUNB-29	2	Trailer Coupler Nut
12	HU3-288	1	Lt. Fr. Leveling Leg Assy	41	PU3-374	1	Safety Chain & Hooks
13	HU3-282	1	Lt. R. Leveling Leg Assy	42	PB3-359	1	Spare Tire U Bolt
14	HU3-288	1	Rt. R. Leveling Leg Assy	43	FB3-360	2	Spare Tire U Bolt Nuts
15	PEBQ2-111	4	Leg Retainer Spring	44	PUN1-2AR	2	Tire-Tube & Rim Assy
16	PU3-385	1	Axle	45	PUN1-5R	2	Rim
17	PUNO-13R	2	Axle Nut	46	PUNB-4	2	Tube
18	PUNB-14	2	Cotter Key	47	PUN1-3R	2	Tire
19	PUN9-7R	2	Hub	48	PB3-400	1	Floor Panel
20	PUN2-39	4	Races	49	MBNB-23	4	Rear Shackle Links
21	PUNB-10	4	Wheel Bearings	50	MBNB-16	2	U Bolt Plate
22	PUNB-11	2	Wheel Bearing Gr. Seal	51	MEBQ2-114	1	Tongue Clamp
23	PUNB-8	2	Wheel Bearing Dust Cap	52	PU3-469	1	Trailer Coupler
24	PU3-386	2	Leaf Spring	53	PUNB-28	8	Shackle Mt. Bolts
25	SU3-322	1	Rt. Fr. Shackle Mount	54	PUNB-29	8	Shackle Mt. Nuts
26	SU3-321	1	Lt. Fr. Shackle Mount	55	PB3-470	1	Tongue Clip For Wiring
27	SU3-320	1	Rt. R. Shackle Mount	56	MB3-304	1	Rear Reinforcing Angle
28	SU3-319	1	Lt. R. Shackle Mount	57	PUNO-30	2	Lock Washer
29	PUNO-25R	6	Shackle Bolt				

R-CARRIAGE

PARTS LIST

APACHE CHIEF CAMPING TRAILER

Item	Part No.	Req.	Description	Item	Part No.	Req.	Description
1	MB3-228	1	Front Body Panel	34	MBQ9-46	1	License Plate Bracket
2	MB3-229	1	L.S. Fr. Body Panel	35	PB3-413	1	Chief Name Plate
3	MB3-230	1	Rt. S. Fr. Body Panel	36	PE3-364	1	Wiring Harness
4	MB3-231	1	Lt. S. R. Body Panel	37	PE3-365	2	Comb. Stop & Tail Lite
5	MB3-232	1	Rt. S. R. Body Panel	38	PE3-366	2	Tail Lite
6	MB3-235	1	R. Body Panel	39	PEL9-7		Tail Lite Lens Only
7	SB3-237	2	Door Assy-No Handles	40	PBQ2-47R	1	Apache Name Plate
8	SB3-310	2	Lock Handle Assy w/L&K	41	PB3-415	2	Door Weatherseal
9	SB3-315	2	Lock Handle Ass'y	42	MB3-495	1	Left Front Body Trim
10	MB3-239	1	Body Center Partition	43	MB3-497	1	Left Rear Body Trim
11	MB3-240	1	Body Cross Partition RH	44	MB3-494	1	Right Front Body Trim
12	MB3-241	1	Body Cross Partition LH	45	MB3-496	1	Right Rear Body Trim
13	MB3-274	2	Dr. Hinge Apron Molding	46	MB3-493	2	Door Trim Molding
14	MB3-404	2	Door Frame	47	MB3-276	2	Door Hinge
15	MB3-267	1	Front Bed Rail	48	ST3-476		Tent Ass'y
16	MB3-267	1	Rear Bed Rail	49	PBQO-87	2	Lock Cylinder & Key
17	MB3-268	2	Side Bed Rail	50	PB3-703		Key Only
18	MB3-256	4	Adjustable Dr. Strike	51	PT3-455		Tent Wire Spring Clip
19	MA3-311	1	Bed Bow	52	PTB8-15		12" Tent Stakes
20	MA3-312	1	Cent. Bow Upper Half	53	RTE8-11		1/2" Sisal Rope
21	MA3-431	2	Cent. Telescope Bow 36"	54	PTB8-14		Galvanized Rope Slide
22	MA3-312	1	Ridge Bow Upper Half	55	ST3-549B	2	Wind. Flap Zipper 49"
23	MA3-436	2	Ridge Telescope Bow	56	ST3-551B	1	Wind. Flap Zipper 51"
24	MB3-324	2	Bow Pivot Plate	57	ST3-557B	4	Wind. Top Flap Zip. 57"
25	MB3-408	4	Stay Hinge Rod	58	ST3-584D	1	Door Zipper 84"
26	MB3-409	4	Stay Hinge Guide	59	ST3-663	1	Add A Room Zipper 62"
27	PB3-410	8	1/2x20x1/2 Shoulder Bolt	60	ST3-6102	1	Add A Room Zipper 94"
28	MB3-411	4	Bed Rail Cor. Cap Upper	61	ST3-6144	1	Canopy Zipper 144"
29	MB3-412	4	Bed Rail Cor. Cap Lower	62	SB3-438		Road Cover Ass'y
30	MB3-401	1	Bed Bottom	63	PTB2-25A		Elastic Tie Down w/Hook
31	ST3-432	1	Mattress	64	PB3-701	4	Body Corner Cap Screw
32	SB3-308	4	Telescope Latch Ass'y	65	PBQ2-124		Name Plate Speed Clip
33	PB3-340	24	Body Slide Snaps	66	PTBQ-18	2	9" Tent Stake

BODY & TENT